

Eco Motion

DC

Installation Manual

fanco●

Ceiling fan instruction booklet
Thank you for purchasing your Fanco Eco Motion DC Ceiling Fan. Please read all instructions carefully before assembly and use.

IMPORTANT SAFEGUARDS

Read all instructions carefully, even if you feel you are quite familiar with this type of appliance. When using electrical appliances, in order to reduce the risk of fire, electric shock, and/or injury, these basic safety precautions should always be followed:

1. All wiring must be done by a licenced electrician as on-site warranty may be voided if proof cannot be provided. This ceiling fan MUST be installed by a Qualified Electrical Contractor in accordance with the local regulations, and all local, state and national electrical codes. Any alterations or additions to building wiring must be completed by a licensed electrical contractor, or person authorised by legislation to work on the fixed wiring of any electrical installation.
2. The fan must be connected to a 240V AC 50Hz power supply.
3. All electrical work must only be undertaken after disconnection of the power by removing fuses or turning off the circuit breaker, to ensure all pole isolation of the electrical supply.
4. The fan must be earthed.
5. The fan must be installed so that the blades are at least 2.1 metres above the floor.
6. The ceiling fan weight is max. 6 kg. The structure that the ceiling fan is mounted to must be capable of supporting a weight of at least 45 kg. The fixing must be able to support the moving weight of the fan and must not twist or work loose.
7. Make sure that the installation site will not allow the rotating fan blades to come into contact with any object and that there is enough space from the blade tip to the wall or ceiling. Please note that insufficient clearance distances might cause wobbling and the bigger this clearance is the better the airflow from your fan will be.
8. This product can be installed in a position where it is covered or enclosed al fresco areas and there is a minimum clearance of 1.50 m from the blade tip to all edges of the roof or positions where could be exposed to water, moisture or other dangerous external elements.
9. DO NOT connect the fan motor to a dimmer switch. This may give an unsatisfactory performance (motor hum) and cause damage to the motor and/or controller. Use ONLY the provided remote control.
10. This appliance is not intended for use by young children or infirm persons without supervision.
11. Young children should be supervised to ensure that they DO NOT play with the appliance.
12. It is NOT recommended that ceiling fans and gas appliances be operated in the same room at the same time.
13. The fan must be turned off and stopped completely before reversing the fan direction. This will prevent any damage to the motor of the fan or controller.
14. Do not insert anything into the fan blades whilst they are spinning. This will damage the blades and upset the balance of the fan causing the unit to wobble.
15. After the fan is completely installed make sure that all base and fan blade fixings are secured and tightened to prevent any problems.
16. Because of the fan's natural movement, some connections may loosen. Check the support connections, brackets and blade attachments twice a year to make sure they remain secured. If any are loose, tighten.
17. If unusual oscillating movement is observed, immediately stop using the ceiling fan and contact the manufacturer, its service agent or suitably qualified persons.
18. The replacement of parts of the safety suspension system device shall be performed by the manufacturer, its service agent or suitably qualified persons.

19. If it is necessary to replace the live or neutral brushes to ensure operation of the motor then both brushes and the earth brush shall be replaced at the same time. The brushes shall only be replaced by a suitably qualified person.
20. An all-pole disconnection incorporated in the fixed wiring is to be provided, such as an all-pole switch or a supply cord fitted with a plug.
21. The light source in light kit is not replaceable; when the light source reaches its end of life the whole light kit shall be replaced by manufacture, his service agent or a qualified person.
22. The max operating temperature for the fan is 40°C. Keep the fan away from any heat sources, like fire place, heater and stove.

IMPORTANT NOTE:

The important safeguards and instructions given in this manual are not meant to cover all possible conditions and situations that may occur. It must be understood that common sense, caution and care are factors which cannot be built into any product.

CAUTION:

Do not ingest battery - Chemical burn hazard.

The remote available as an accessory for this product contains AAA batteries. If the battery is swallowed, it can cause severe internal burns in just 2 hours and can lead to death.

Keep the new and used batteries away from children. Examine devices and make sure the battery compartment is secure.

If the battery compartment does not close securely, stop using the product and keep it away from children.

If you think batteries might have been swallowed or placed inside any part of the body, seek immediate medical attention.

Call the Poisons Information Centre on 13 11 26 or go to a hospital emergency room.

Do not let the child eat or drink and do not induce vomiting. Dispose of used button batteries immediately.

Flat batteries can still be dangerous.

The battery supplied with this product is not to be recharged.

Different types of batteries or new and used batteries are not to be mixed. Battery to be inserted with the correct polarity. + for positive, - for negative.

Exhausted batteries are to be removed from the appliance and safely disposed of.

If the appliance is to be stored unused for a long period, the batteries should be removed.

Dispose of used button batteries immediately.

Flat batteries can still be dangerous. the supply terminals are not to be short-circuited.

FAULT FINDER:

Always check the "Trouble Shooting Checklist" included in this booklet before seeking warranty claim.

Mechanical noise may be noticed on installation. Allow at least 8 hours settling-in period. Some fans may wobble more than others, even if they are identical. This does not necessarily indicate a fault.

PREPARATION:

1. Unpack your ceiling fan carefully, then remove all parts and components, and lay on a cloth or soft surface to avoid damage. DO NOT lay the motor housing on its side, the housing may get damaged.
2. Before commencing installation, check that all parts are included.

NB: You may need to remove all foam packaging material to ensure there are no missing parts.

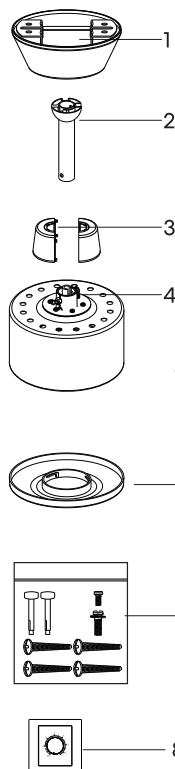

Serial number	name	Pieces
1	Bracket ,Canopy	X1
2	Downrod	X1
3	Motor hub cap	X1
4	Motor	X1
5	Blade	X3/5
6	lamp plate or Base plate	X1
7	Screw bag	X1
8	Wall Control	X1

screw package details		
pattern	name	Pieces
	Expansion Screws	X2
	Screw	X1
	Screw	X1
	Self tapping screws	X4

INSTALLATION AND ASSEMBLY

CAUTION: Before installing the fan make sure you have turned OFF the electricity supply.

SELECTING A LOCATION:

1. Choose a location for mounting the fan where the blades will have at least 2.1 metres of clearance from the floor.
2. Make sure that the installation site will not allow the rotating fan blades to come into contact with any object and that there is enough space from the blade tip to the wall or ceiling. Please note that insufficient clearance distances might cause wobbling and the bigger this clearance is the better the airflow from your fan will be.
3. This product can be installed in a position where it is covered or enclosed al fresco areas and there is a minimum clearance of 1.50 m from the blade tip to all edges of the roof or positions where could be exposed to water, moisture or other dangerous external elements.
4. Secure the hanging bracket to the ceiling joist or suitable structure that is capable of carrying a load of at least 45 kg, with the two long fixing screws provided. Ensure that at least 30mm of the screw is threaded into the support.

The fixing screws included are designed for use when ceiling fan is secured onto timber joists. For all other surfaces, additional and suitable fixing screws for that surface will need to be purchased.

ELECTRICAL CONNECTIONS

- Ensure the power is off when installing this fan.

WIRING DIAGRAM - WITH WALL CONTROL

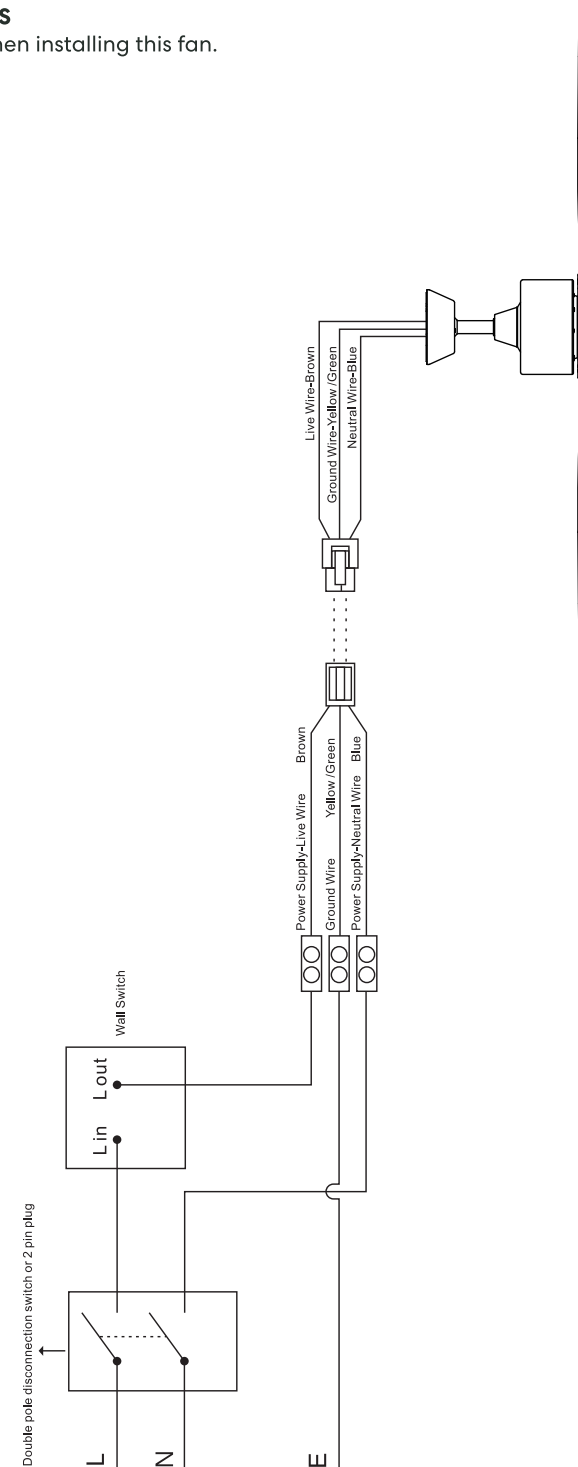

2.1 Separate the bracket from the canopy

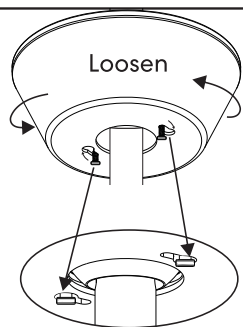
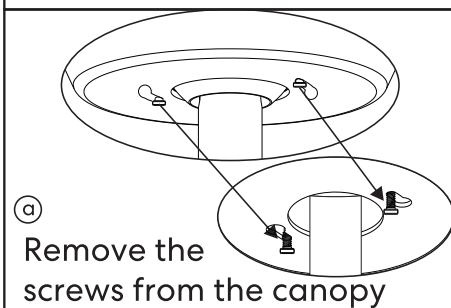
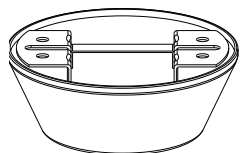

(c) Remove bracket from canopy

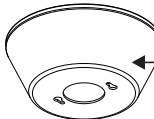
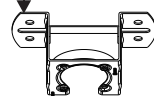
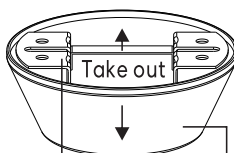

2.2 Ceiling

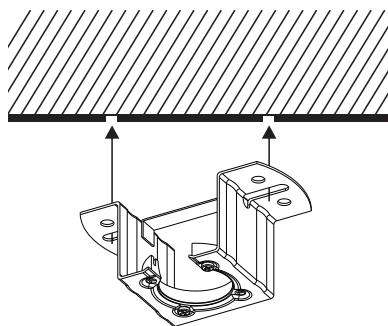

Make location point for bracket

2.4 Concrete ceiling

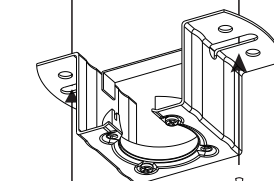

Drill hole

Deep 50mm

Expansion screws for concrete use

2.5 Timber ceiling

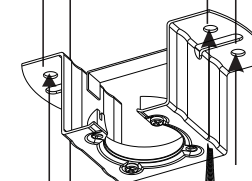

Pre drill

4 self tapping screws for timber mounting surface and lock the screw to the end

① Turn motor upside down

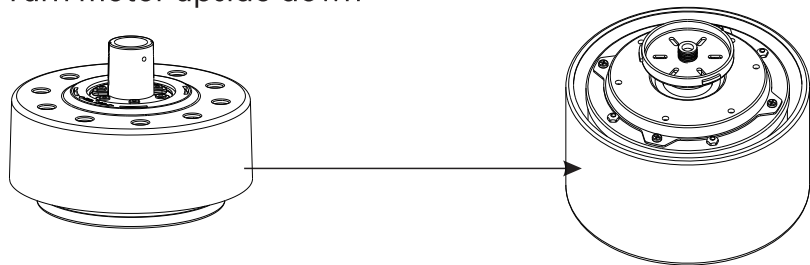

② Remove the blade holders

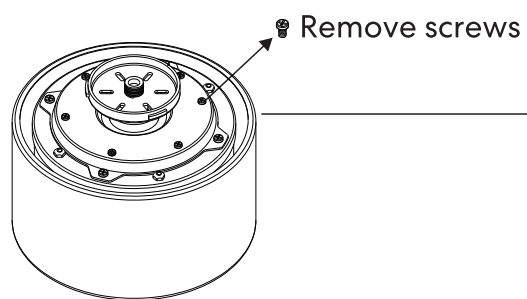

③ Aligning the screw hole of blade and blade holder

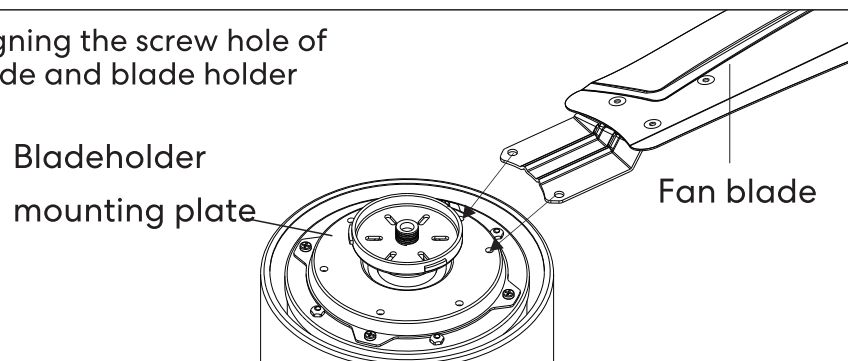

④ Install the blades and tighten the screws

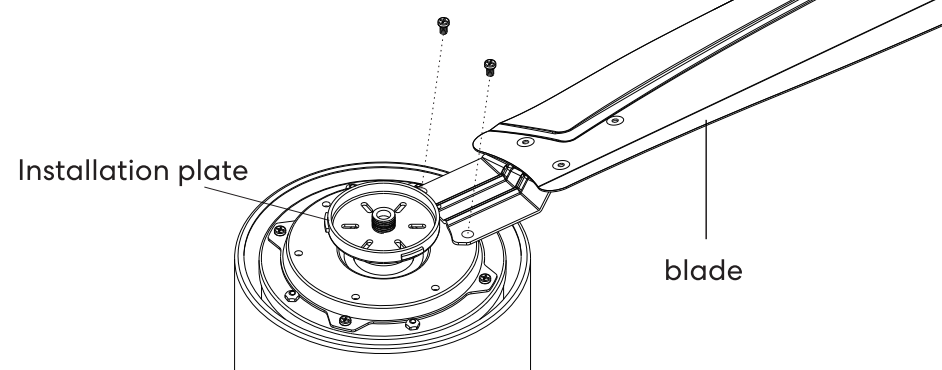

⚠ Make sure all the blades are smooth after installation

3.2 Downrod & Canopy Installation

① Remove the screws on the yoke

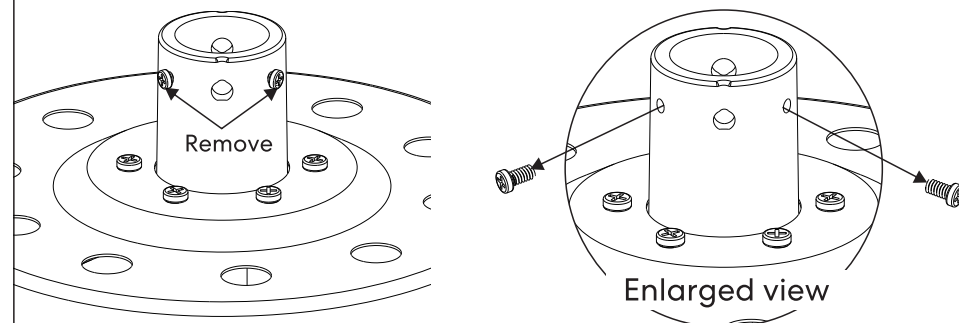

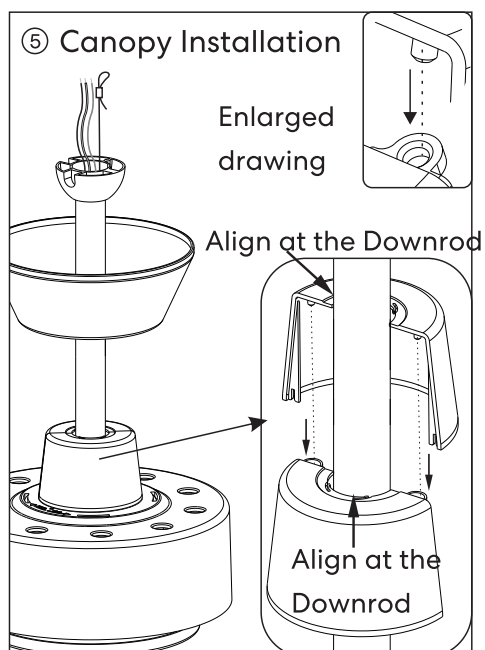
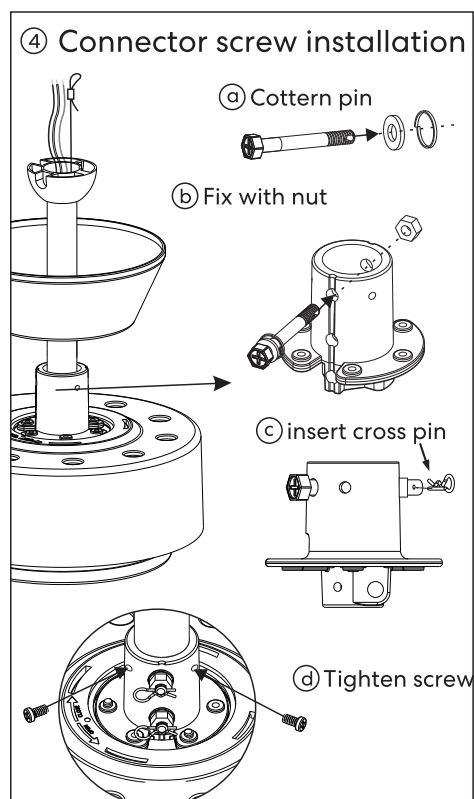
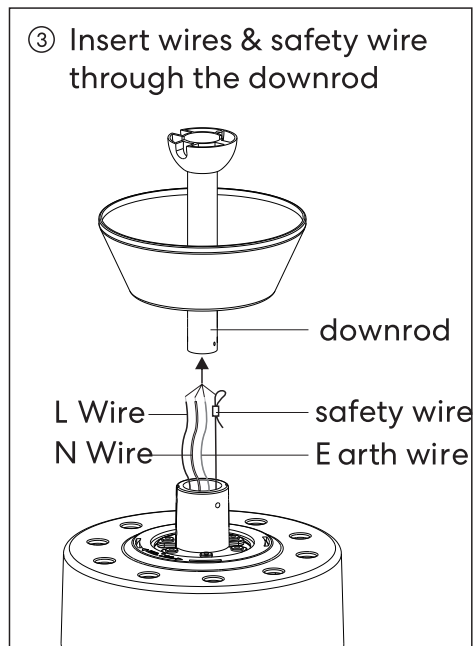
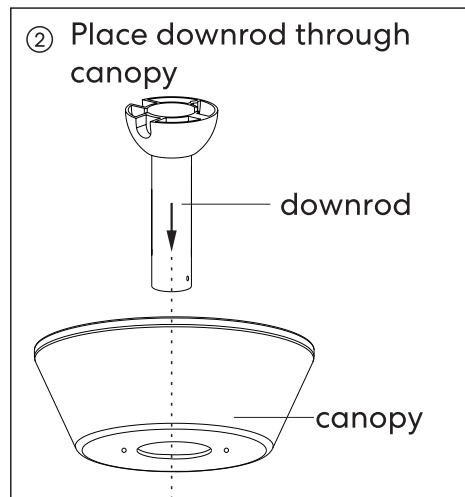

3.3 Hang the Fan

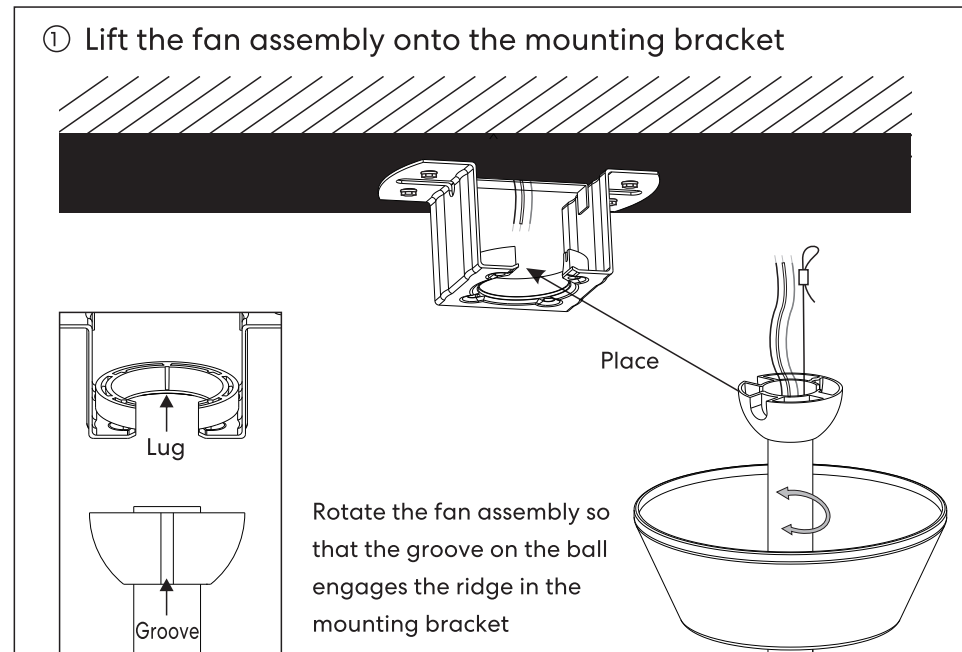

3.4 Wiring

- ① Wiring method is as follows

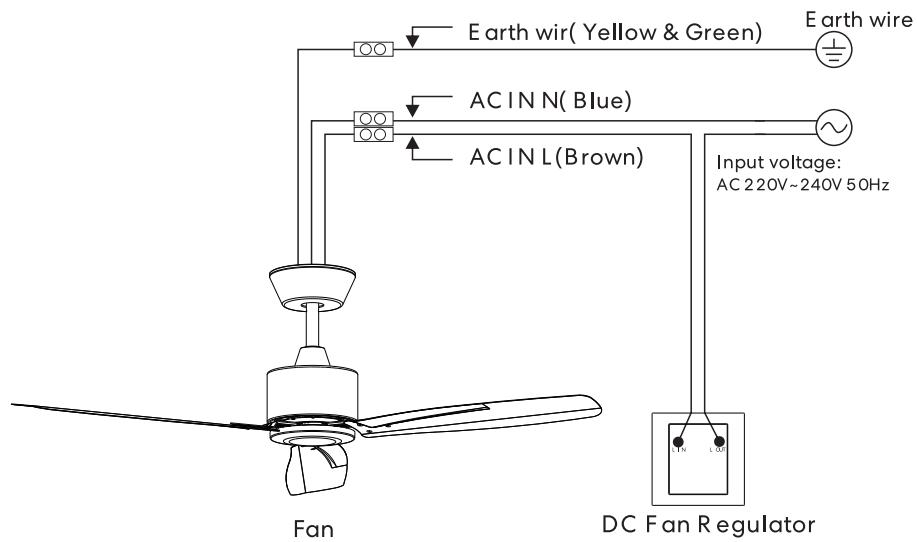

3.5 Canopy Installation

- ① Lift up the canopy until the holes on the canopy match the holes in the mounting bracket

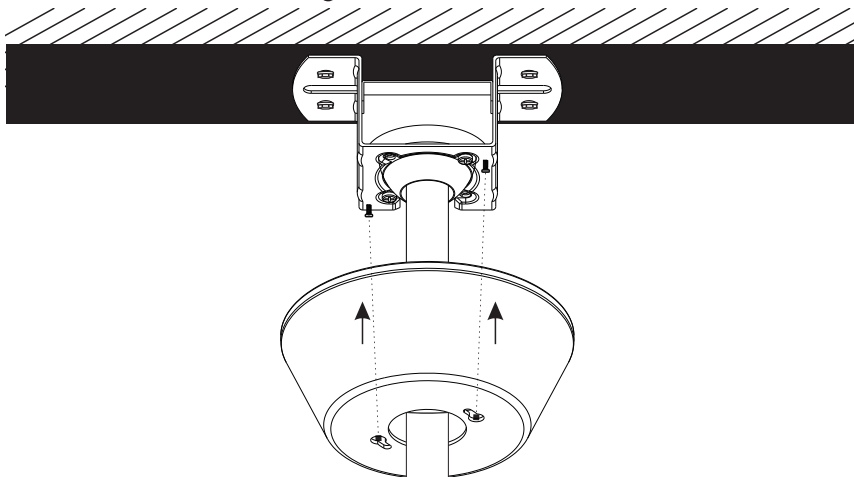

- ② After alignment, make sure the screws on the canopy are tightened

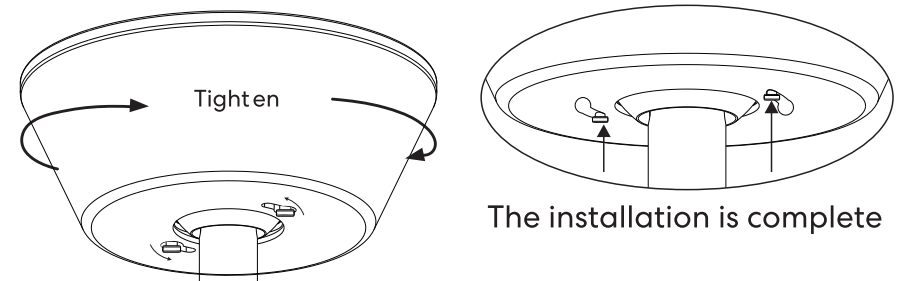

- ! Rotate the canopy to align the holes and secure the canopy to the mounting bracket & tighten the screws

3.6 Base Plate Installation

- ① Install base plate as per below

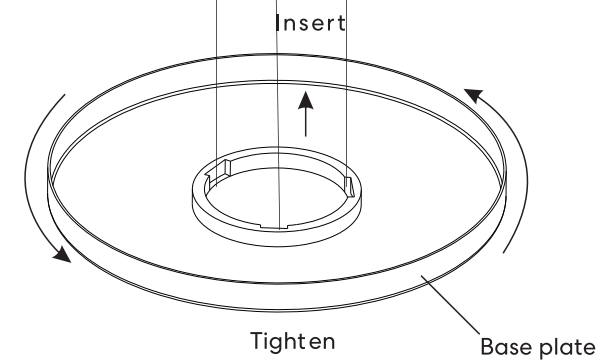
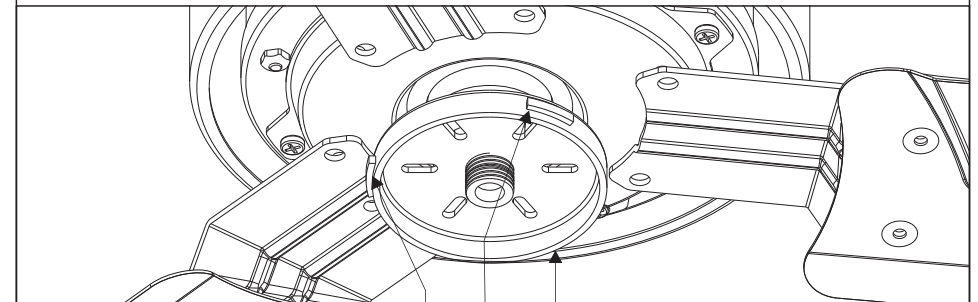

CARE & CLEANING:

- Periodic cleaning (approximately 6 months) of your ceiling fan is the only maintenance required.
- Use a soft brush or lint free cloth to avoid scratching the finish. Please turn off electricity when you do so.
- Do not use water when cleaning your ceiling fan. It could damage the motor or the wooden blades and create the possibility of an electrical shock.
- The motor has a permanently lubricated ball bearing and as such, is maintenance free.

NOISE:

The manufacturer warranty covers actual faults that may develop, but NOT minor complaints, e.g. motor operation noise - ALL ELECTRIC MOTORS ARE AUDIBLE TO SOME EXTENT; this is more obvious when the fan is operating at low speeds.

WOBBLE:

- Ceiling fans are designed to move during operation because they are not generally rigidly mounted
- Movement of a couple of centimetres is acceptable for safe operation.
- Balancing kits included should be used to adjust the balancing when first installed.

NORMAL WEAR AND TEAR:

Threaded components working slightly loose or blade carriers even slightly bent due to vigorous cleaning or bumping can cause extra wobble and noise. THIS IS NOT COVERED UNDER WARRANTY, but a little care and maintenance can reduce or prevent this problem.

WIRING DIAGRAM - WITH REMOTE

REMOTE IS PURCHASED SEPARATELY AS AN OPTIONAL ACCESSORY

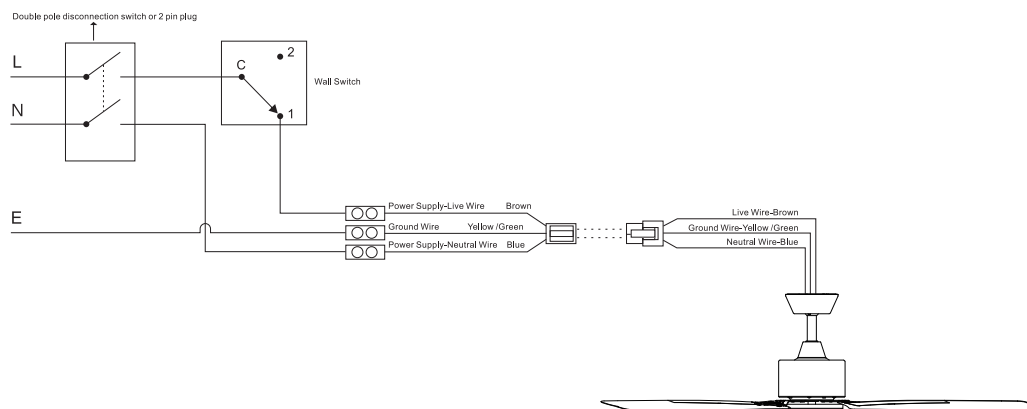

How to install the fan with remote control

Note: Remote control kit is not included in the box and can be separately purchased from Fanco. To control the fan with remote, the receiver pre-assembled inside the motor needs to be replaced with the receiver in remote control kit.

1. Remove the screws on the top of the motor and take off the motor housing.

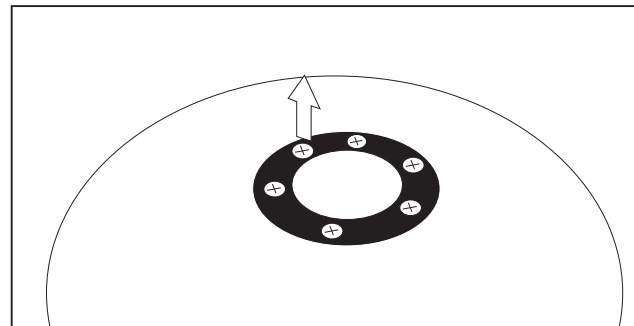

2. Gently remove the pre-assembled receiver from the connection and replace with remote control receiver in the accessory pack.

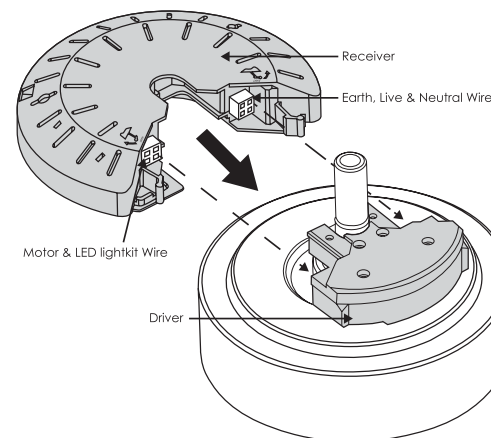

3. Install the motor housing back and secure with screws.

4. Follow the same installation steps as fans with wall control.

REVERSE FUNCTION

The "Summer/Winter" reverse function is included in the remote control to make the fan rotate in an anti-clockwise direction during summer. In winter, this can be reversed, so that the blades now move in a clockwise direction. Press and hold "F/R" button for 3 seconds to switch between "Summer" and "Winter" modes.

REMOTE CONTROL SETTINGS AND OPERATION FOR DC FANS

NOTE:

The Hand Held Remote Control System is equipped with a learning frequency function which has code combinations to prevent potential interference from other remote units. The frequency on your Receiver and Transmitter units have been pre-set at the factory. If the remotes need programming please follow these instructions and use a small size tool to change the code switch setting for each remote.

PAIRING THE REMOTE:

All fans are pre-paired and there is no pairing process needed to start the fan. If you want to reset the fan to factory setting. Please follow steps below.

1. Connect power to the fan.
2. Within 10 seconds after turning on the power, press the "ON/OFF" button 3 times, followed by the 4th press and hold the button for 3 seconds. Then, the fan will beep once and it means it's paired successfully.
3. Now test the remote by pressing on speeds or light button.
4. It can take up to 10 seconds for the fan to start moving, after pressing a speed button. The fan may move a few times slightly backwards and forwards and then will start rotating slowly whilst building up to the correct speed. This is normal behaviour for DC fans.

Considerations:

1. If the receiver is not receiving a signal from the remote control:
 - a. Please check the battery to ensure it has sufficient power and has been inserted correctly and aligns with the positive and negative terminals; or
 - b. Please check if there are any other similarly remote-controlled objects that work nearby, as remote-controlled items operating on the same frequency may disturb each other.
2. If the battery is low it will affect the sensitivity of the remote control and the signal reception and must be replaced (the LED indicator light will flash a warning when the battery runs low).
3. Please remove the battery if the remote control is not being used for a long time.
4. If multiple fans are installed near the fan to be paired, power to the other fans should be turned off before pairing.

Considerations when installing multiple ceiling fans:

Sometimes you may encounter a remote-control issue when installing multiple fans. For the purposes of this troubleshooting guide:
Fan A uses Remote control A and Receiver A, while Fan B uses Remote control B and Receiver B.

1. Isolate power to one fan only when pairing the remotes

When installing two or more fans, you should manually isolate power to Fan B while completing the pairing process on Fan A. If power is not isolated to one of the fans when the power is restored at the fuse box, then both receivers will be put into "learning mode" such that when you try to pair Remote control A to Receiver A, Receiver B will also be in learning mode and might pair to Remote control A too.

FUNCTIONS OF TRANSMITTER

Note: light buttons are not functional on this model as the fan does not have a light option.

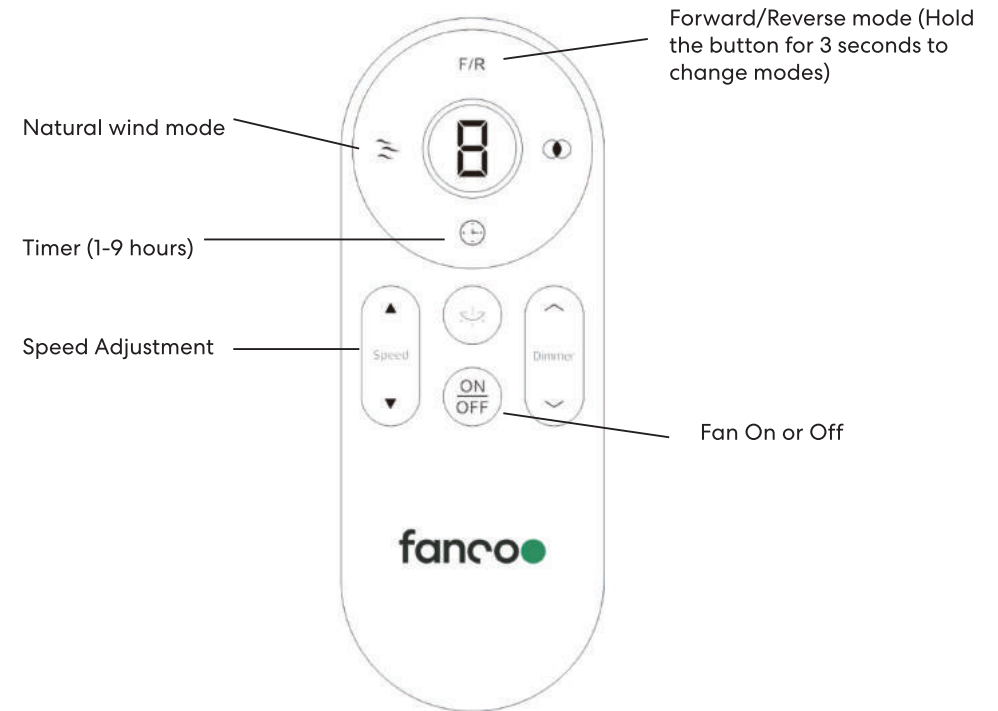

Pairing Process - Press the ON/OFF button 3 times and on the 4th press, hold the button down for at least 3 seconds. A beep sound means that the remote has paired successfully (complete process needs to be finished within 10 seconds).

Trouble	Possible Cause	Suggested Remedy
Fans does not start after pairing process	A) Remote and receiver are not paired successfully B) Battery flat in remote control C) Loose wire connections or plugs to fan/receiver D) No power goes into the fan	A) Re-pair the receiver and remote B) Replace the battery in remote control C) Check wire connections and ensure plugs are positively connected D) Check RCD/Switch board and wiring on premises
Fan keeps beeping, but will not start.	Loose wire connections or plugs to fan/receiver	Check wire connections and ensure plugs are positively connected
Fan wobbles.	A) Screws on down rod are not tightened B) Blades are not balanced	A) Retighten the screws on down rod B) Use the balancing kit to balance the blades.
Fan makes clicking sound.	A) Coupling cover does not sit securely on motor housing B) Rubber ring on coupling cover is removed	A) Adjust coupling cover and ensure it sits properly on the motor housing B) Check couple cover and ensure there's a rubber ring on the top of the cover.

Model Number	Rated Voltage	Motor Consumption	Rated Light Power
CFFCEM4WH	220-240Vac	Max. 45 W DC Motor	N/A
CFFCEM4BL	220-240Vac	Max. 45 W DC Motor	N/A

fanco●