

Hybrid

250

Installation Manual

Before installing your new Fanco Hybrid Exhaust Fan, it is important that you read and follow these instructions prior to installation; even if you feel you are quite familiar with this type of product. Please keep this document handy for future reference as it contains servicing and maintenance requirements.

WARNING:

- Disconnect the fan from power mains prior to any connection, servicing and repair operations.
- The centrifugal fan weight is 4.13kg. The structure that the centrifugal fan is mounted to must be capable of supporting a weight of at least 20kg. The fixing must be able to support the moving weight of the fan and must not twist or become loose.
- If the supply cord is damaged, it must be replaced by the manufacturer or qualified persons in order to avoid a hazard.
- Mounting and maintenance should only be conducted by qualified electricians with a valid electrical work permit (for electric operations for units up to 1000V) and only after careful review of the present user's manual.
- The single-phase power mains must comply with the acting local electrical norms and standards.
- The fixed electrical wiring must be equipped with an automatic circuit breaker. The fan must be connected to mains power through an automatic circuit breaker (QF Integrated - as per wiring diagram below) into the fixed wiring system, with the gap between the breaker contacts on all poles no less than 3mm.
- Check the fan for any visible damages of the impeller and the casing before starting installation.
- The casing internals must be free of any foreign objects which can damage the impeller blades.
- Misuse of the device or any unauthorised modification is not allowed.
- The fan is not to be used by children and persons with reduced physical, mental or sensory capacities, without proper practical experience or expertise, unless they are controlled or instructed on the product operation by the person(s) responsible for their safety.
- Do not leave children unattended and do not let them play with the product.
- Take steps to prevent ingress of smoke, carbon monoxide and other combustion products into the room through open chimney flues or other fire-protection devices. Sufficient air supply must be provided for proper combustion and exhaust of gases through the chimney of fuel burning equipment to prevent back drafting.
- Transporting medium must not contain any dust or other solid impurities, sticky substances or fibrous materials.
- **DO NOT** use the fan in the environment containing hazardous or explosive materials and vapours, i.e., spirits, gasoline, insecticides, etc.
- **DO NOT** close or block the fan intake or extract vents in order to ensure the most effective air passage.
- **DO NOT** sit on the fan and do not put objects on the fan.
- Fulfil the requirements stated in this user's manual to ensure long service life of the product.
- The Hybrid centrifugal exhaust fan described in this user's manual is designed for exhaust ventilation of small to medium-sized premises.

RECYCLE AT THE END OF THE SERVICE LIFE.

DO NOT DISPOSE THE PRODUCT WITH UNSORTED MUNICIPAL TRASH.

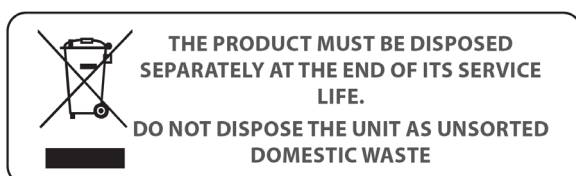

DELIVERY SET:

- Fan Motor: 1 piece (note that the decorative or light grille is packaged separately)
- Hole size cut-out template: 1 piece (attached to the box)
- User's manual: 1 piece
- Packing box: 1 piece

SHORT DESCRIPTION:

- The unit described here is a centrifugal fan for exhaust ventilation of small to medium premises.
- The fan casing is made from white plastic.
- The extract spigot with a non-return valve is attached to the fan to prevent back air flow.
- The fan is equipped with a single-phase electric motor.
- The fan is designed for connection to $\varnothing 150\text{mm}$ air ducts.
- Due to constant improvements the design of some models may slightly differ from those ones described in this manual.

OPERATION RULES:

- The fan is designed for connection to AC 220-240 V, 50 Hz power mains.
- Ingress protection rating against access to hazardous parts and water ingress: IPX4
- The fan is designed for indoor application only with the ambient temperature ranging from $+1^{\circ}\text{C}$ up to $+45^{\circ}\text{C}$ and relative humidity up to 80%.
- The unit is rated as a Level 3 electrical appliance.

Please Note: If installation of a power socket is required, it must be carried out by a Licenced Electrical Contractor in accordance to AS/NZS3000.

- **DO NOT** operate in high temperature areas such as above or adjacent to cooking equipment.
- It is not designed for external use.

PRODUCT DIMENSIONS (MM):

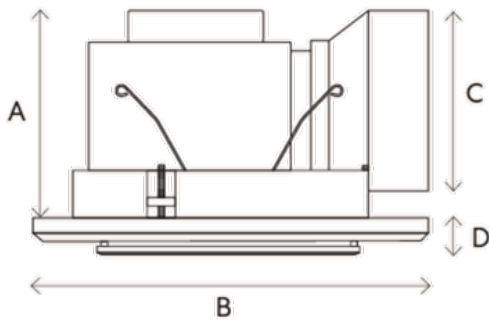

Model	A	B	C	D	Cutout
250	198	$\varnothing 330$	$\varnothing 148$	38	$\varnothing 300$

Minimum install depth 220mm

MOUNTING:

The fan is designed for ceiling mounting and installation in gyprock/plasterboard and is securely fastened by using removable rotary clamping brackets on the fan casing. The fan installation location must comply with local building codes for this type of product. Check the fan for mechanical damages prior to mounting. The minimum install depth should be 220mm.

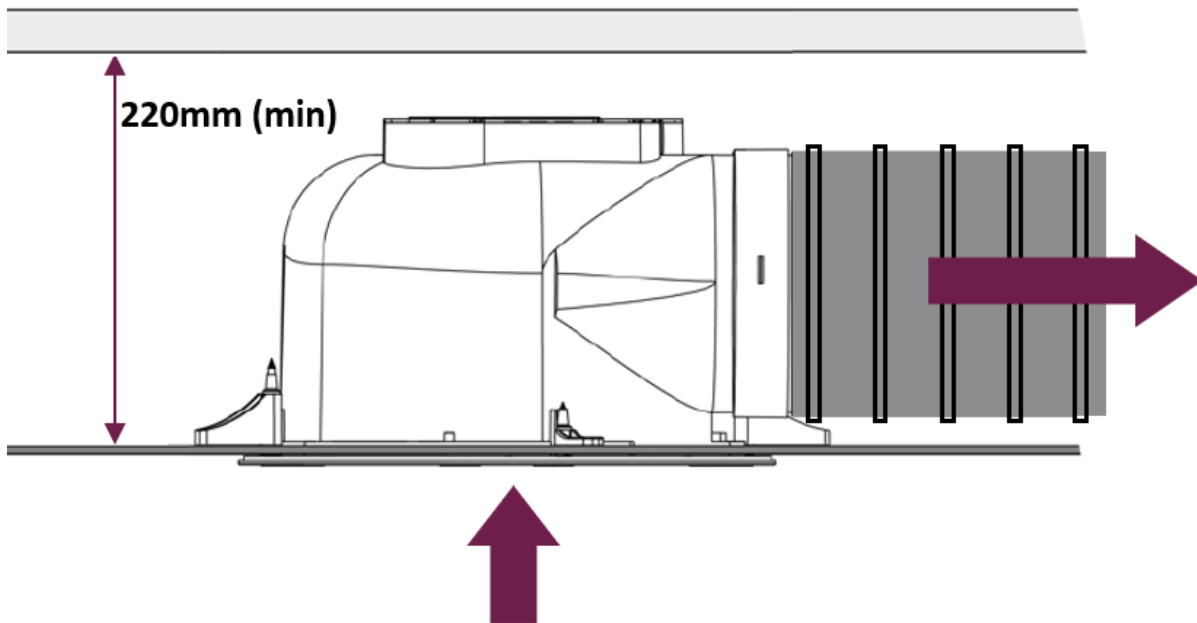

INSTALLTION:

This fan can be installed with a standard cover (no light) or with a light option. Please ensure you are following the directions for the correct installation.

1. Cut off power supply and make preparations in the room to install a fan.

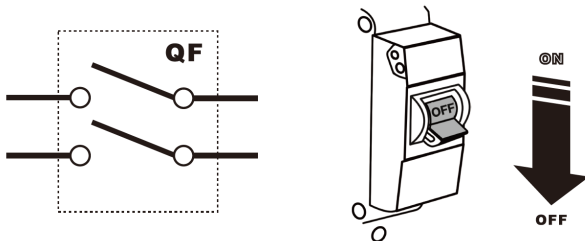

2. Use the provided hole size template to mark the mounting location for the fan and make a round hole in the ceiling of $\varnothing 300\text{mm}$.

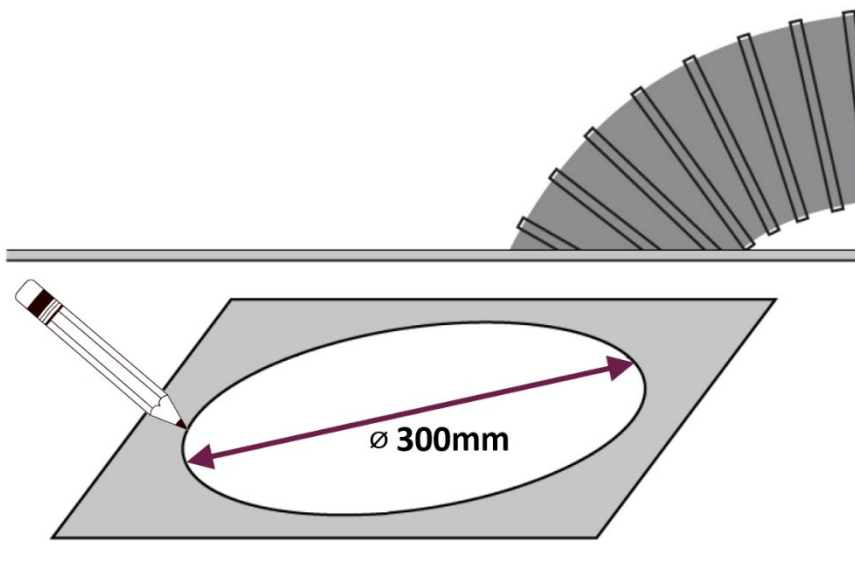

3. Push the ducting through the hole in the ceiling and attach it onto the duct connector (which has a non-return valve).

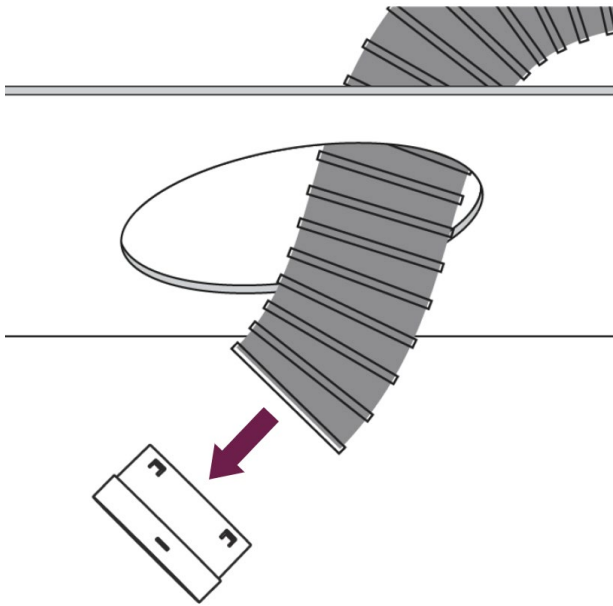

4. Loosen the self-tapping screws on the rocking levers, increasing the gap between the casing and the lever. **DO NOT** remove the rocking levers.

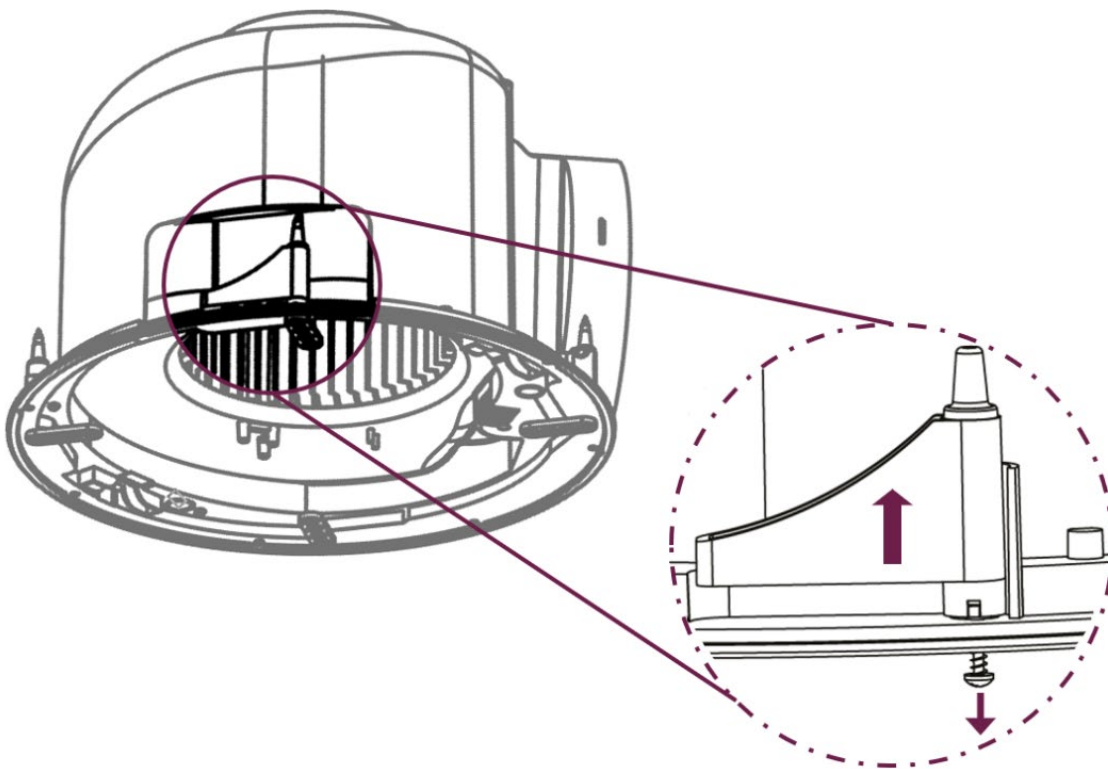

MODELS WITH LIGHT

- a. Locate the light wire holes on the motor.
- b. Carefully cut the light wire hole plastic, making sure the hole is big enough to fit the light wire through.
CAUTION: DO NOT damage the motor structure.

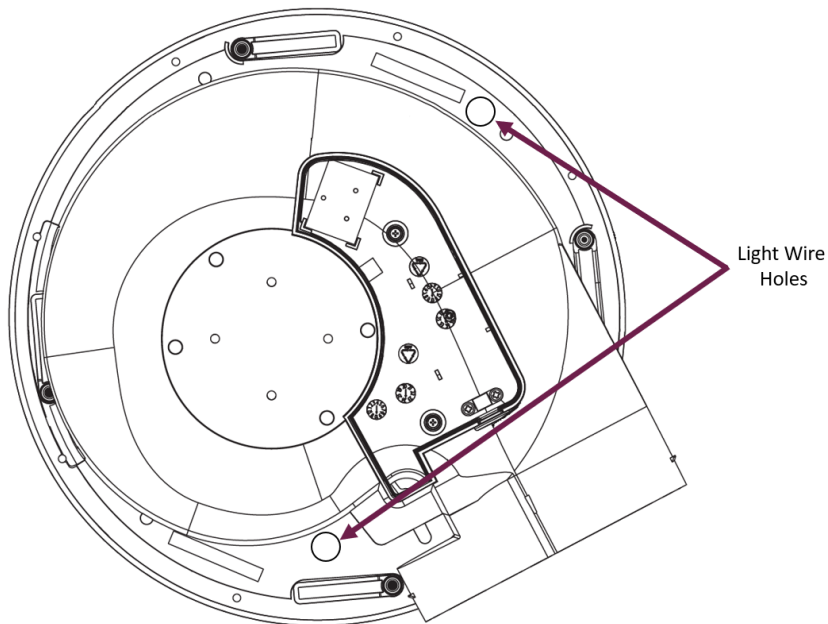

- c. Feed the light wire through the light wire hole.
IMPORTANT: The light transformer will sit on top of the motor, once the motor is installed.

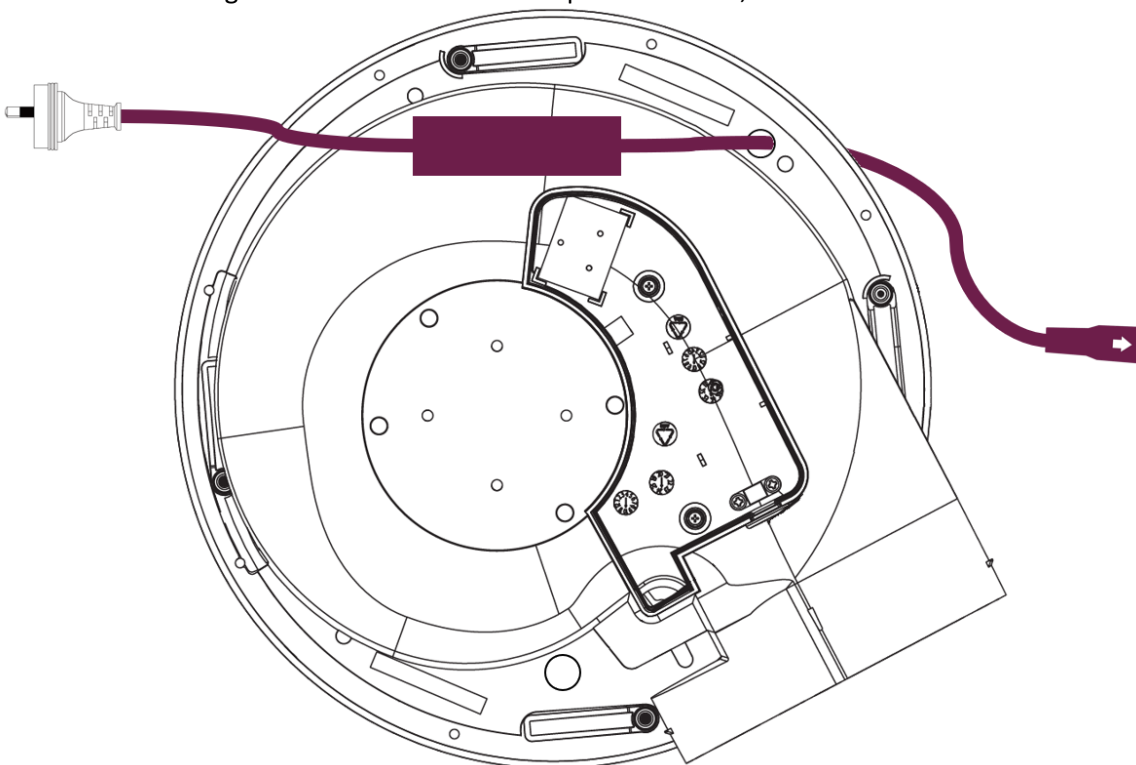

5. Connect the duct connector (and ducting) to the motor. At this point, you can plug the fan into the available power socket in the roofspace.

FOR LIGHT MODELS: Plug the light cable into the available power socket.

CAUTION: A standard socket and electrical wiring to an ON/OFF wall switch must be pre-installed. It is necessary to arrange for a licenced electrician to ensure this is completed before installation of the product.

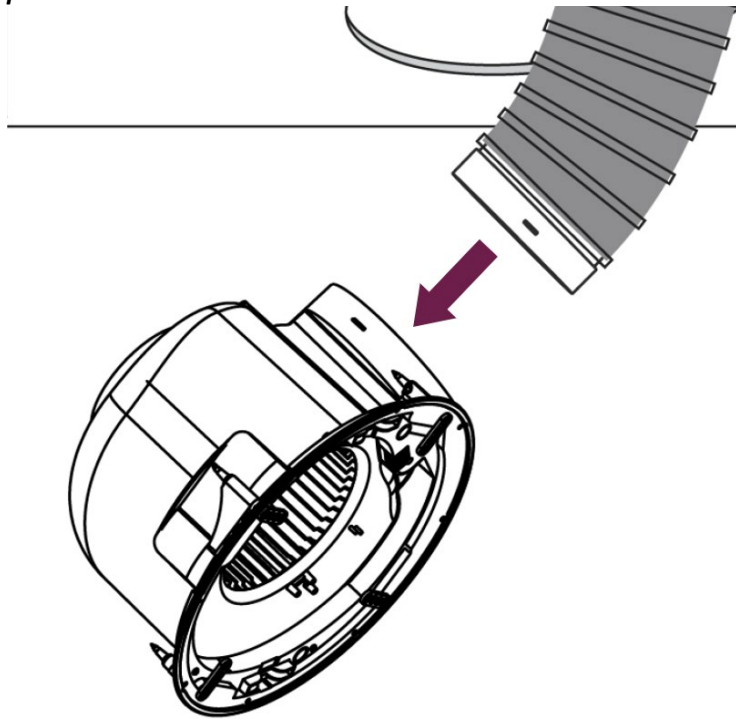

6. Insert the assembled fan into the ceiling opening from the room side.

FOR LIGHT MODELS: Ensure that the light transformer sits on top of the motor.

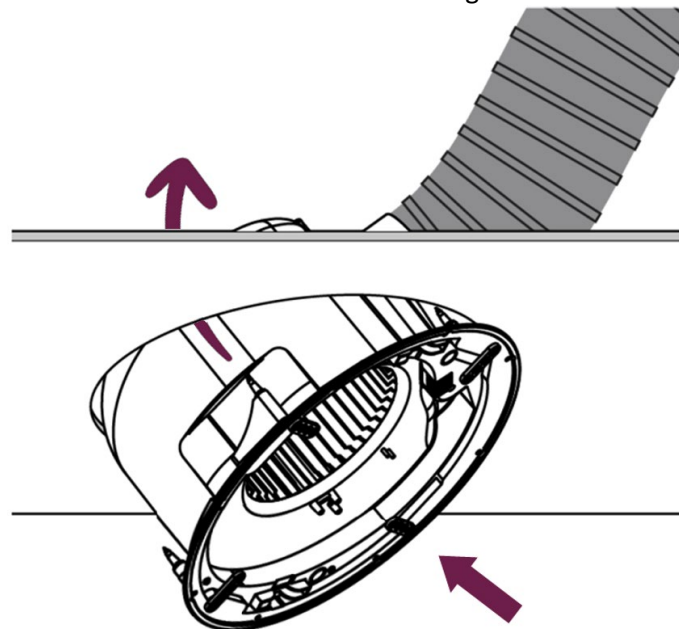

7. Secure the fan in the roof space, by turning the levers.

Inside Room View

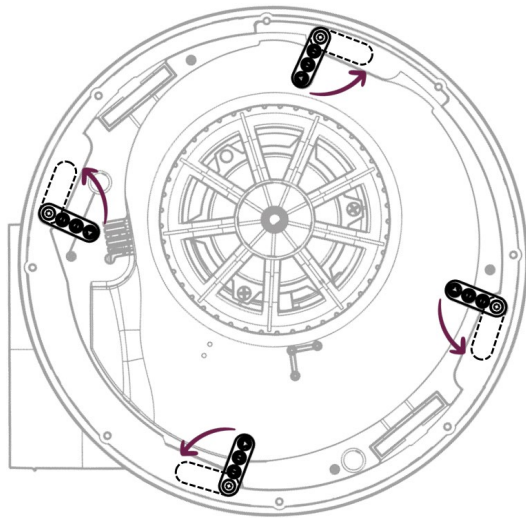

Inside Roof View

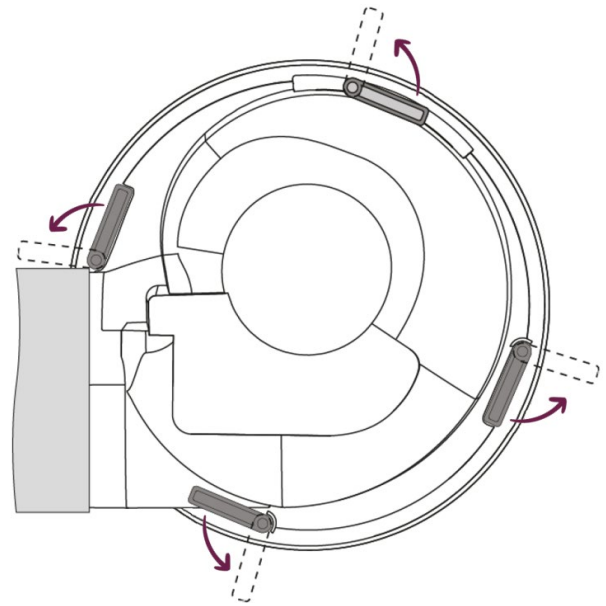

8. Clamp the self-tapping screws on the rocking levers, by using a screwdriver to tighten.

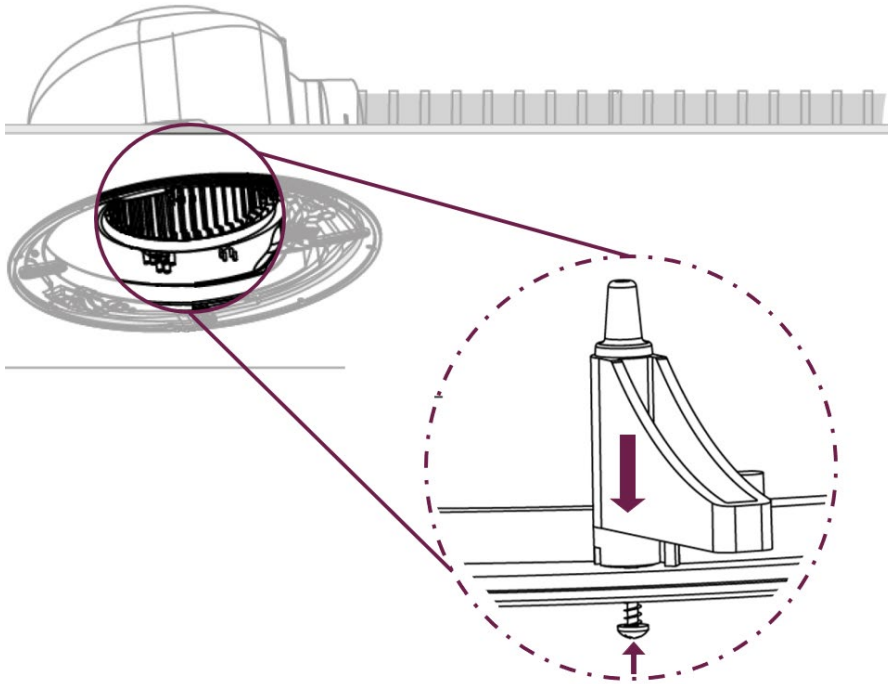

FOR LIGHT MODELS

- a. Connect and lock the two light cables together.

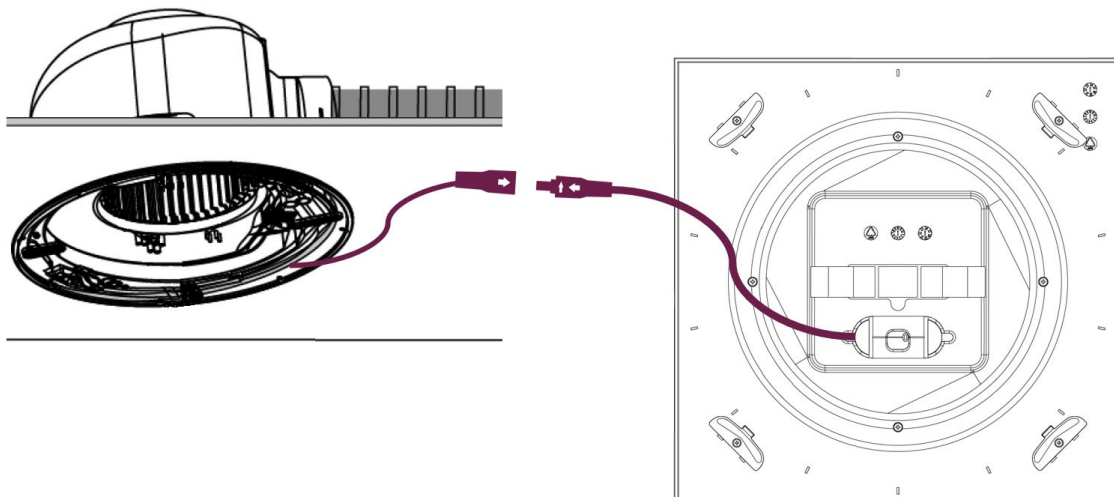

NOTE: You can change the colour of the light to either Warm White 3000K (WW), Natural White 4000k (NW) or Cool White 6500K (CW) using the colour selection switch located on the back of the light panel

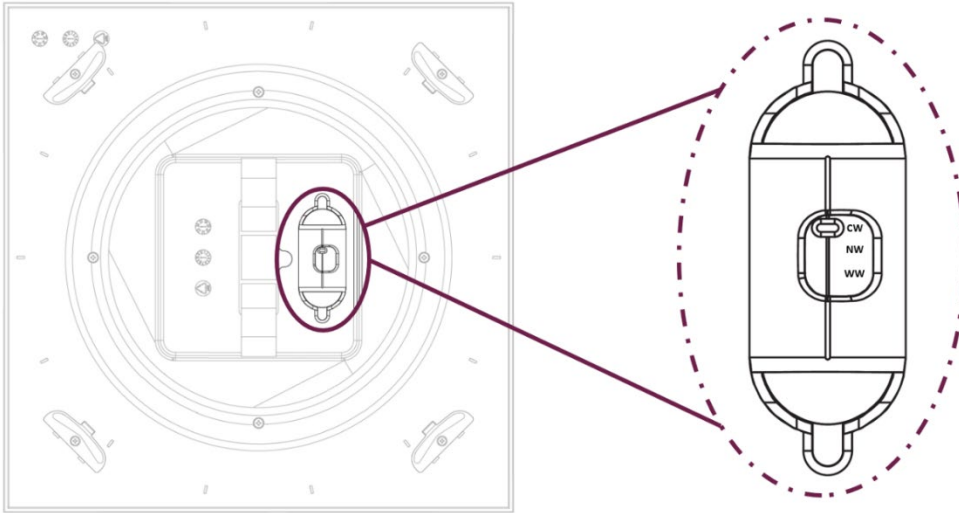

9. Install the fascia, by one of two methods below:

ROUND

a. Locate the mounting holes on the motor.

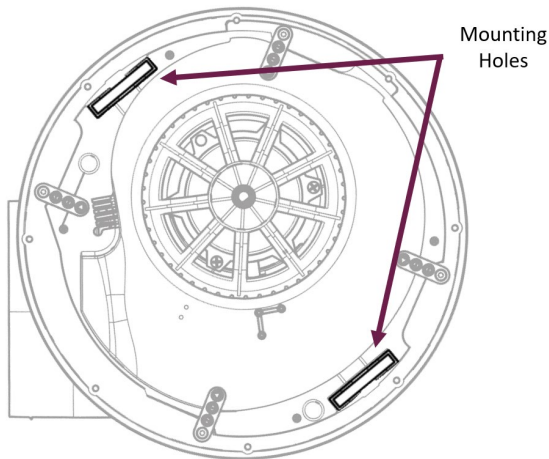

b. Squeezing the springs together on each side, insert the two ends into the mounting holes.

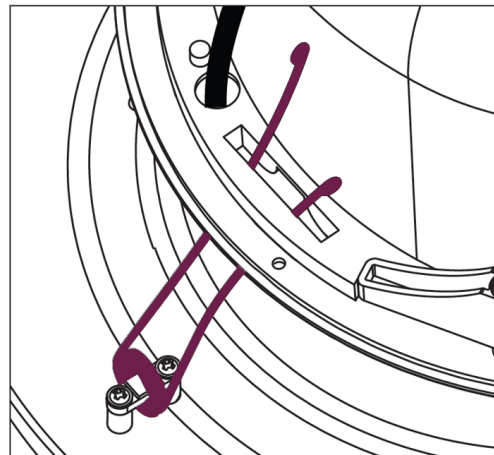

c. Push the fascia towards the motor, until it is flush with the ceiling.

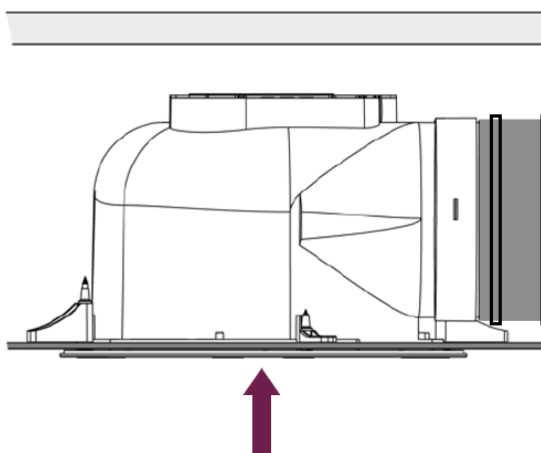

SQUARE

- a. Locate the four (4) hooks on the corner of the fascia.
- b. Start by clipping in two (2) of the hooks of the fascia to the outer circle of the motor face. Then clip in the remaining two (2) hooks by applying gentle pressure to each corner.

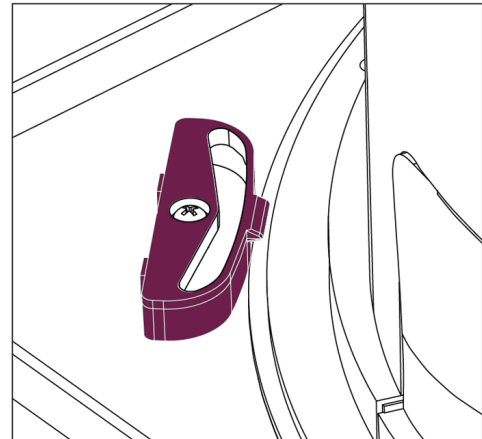
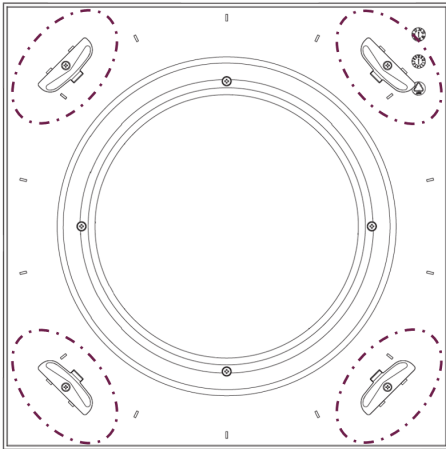

- c. Gently, rotate the fascia to the desired location.

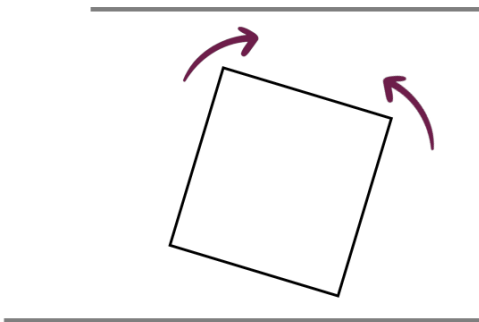

10. Turn on mains power.

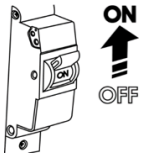

MAINTENANCE:

- The product surfaces must be regularly cleaned from dirt and dust.
- Cut off power supply prior to any maintenance operations.
- Use a soft cloth or compressed air to remove external dust.
- To clean the internal surfaces, remove the decorative cover.

FOR LIGHT MODELS: Before removing the panel completely, unclip the light cable connector

Round Fascia

- a. Pull down the cover slightly
- b. Locate the two springs on each side
- c. Squeeze the springs together (on each side) and remove the springs from the mounting hole

Square Fascia

- a. Unclip one corner
- b. Unclip remaining corners

- Clean the decorative cover using a soft cloth.
- Thoroughly clean every 6 months using a soft dry cloth or a brush.
- After cleaning, mount the decorative cover back on.

- Avoid water dripping on the electric components.
- Supply power to the fan.

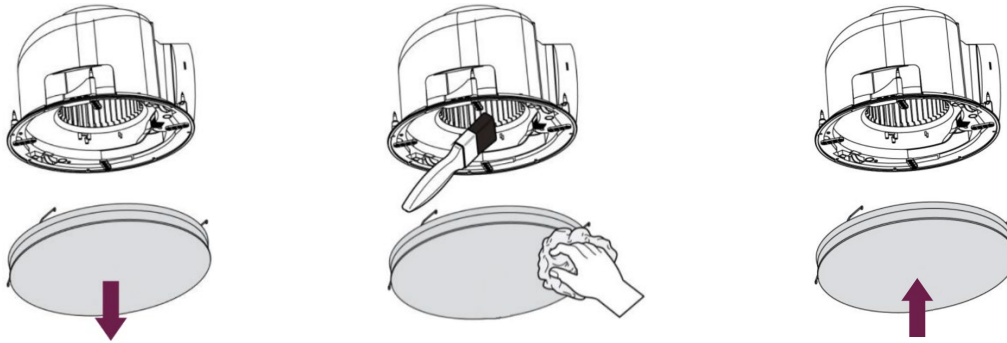

STORAGE REGULATIONS:

- Transport the product by any transportation vehicle in the manufacturer's original package.
- Store the delivered product in the manufacturer's original packing box in a dry ventilated premise with the temperature range from +5°C up to +40°C and relative humidity less than 70%.
- The storage environment must not contain dust, acid or alkali vapours that may cause corrosion of the product parts.

WARRANTY:

Fanco warrants this product against defects in manufacture and workmanship for a period of 2 years from date of purchase when installed for residential use. When installed in a commercial or other non-domestic application, Fanco warrants this product for a period of 3 months from date of purchase.

This warranty is only valid for products installed by a qualified electrical contractor and operated within the guidelines specified by Fanco, and within the correct operating voltage ranges as stated on the product's rating label. Warranty does not include damage or loss arising from incorrect installation, operation or maintenance of this product, damage caused through modification, service by unqualified or unauthorised personnel or lack of regular maintenance and cleaning. Proof of installation by qualified personnel may be required, e.g. Electrical Safety Certificate. Proof of purchase must be supplied with all warranty claims. This warranty is provided in addition to any other rights and remedies of the customer under any law. Fanco does not warrant the costs of removal or re-installation of this product or associated components.

Our goods come with guarantees that cannot be excluded under the Australian Consumer Law. You are entitled to a replacement or refund for a major failure and compensation for any other reasonably foreseeable loss or damage. You are also entitled to have the goods repaired or replaced if goods fail to be of acceptable quality and the failure does not amount to a major failure.

Any claim under this warranty must be made within 2 years of the date of purchase of the product from invoice date. To make a claim under the warranty; at your own expense take the product (with proof of purchase - receipt or similar) to the store where you purchased the product or contact Fanco at the address below:

Fanco Australia

Authorised National Distributor: Universal Fans Australia Pty Ltd

ABN: 44 815 879 311

Address: 18 Cleeland Road, Oakleigh South VIC 3167

Phone: 03 8658 9588

Email: service@fanco.com.au

Model Number	Rated Voltage	Motor Consumption	Rated Light Power
ECVUHBM10	220-240 Vac	Max. 57W	N/A
EAVUHB10RWCOVERLED	220-240 Vac	N/A	18W
EAVUHB10SQWCOVERLED	220-240 Vac	N/A	18W

fanco ●